



# Amelia

## Compartment 1

Amelia County, VA  
1,220.90 Acres

Timbervest Partners, LP  
Amelia Purchase Unit

Mapping #002502  
Accounting #002502

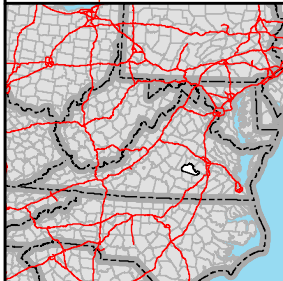
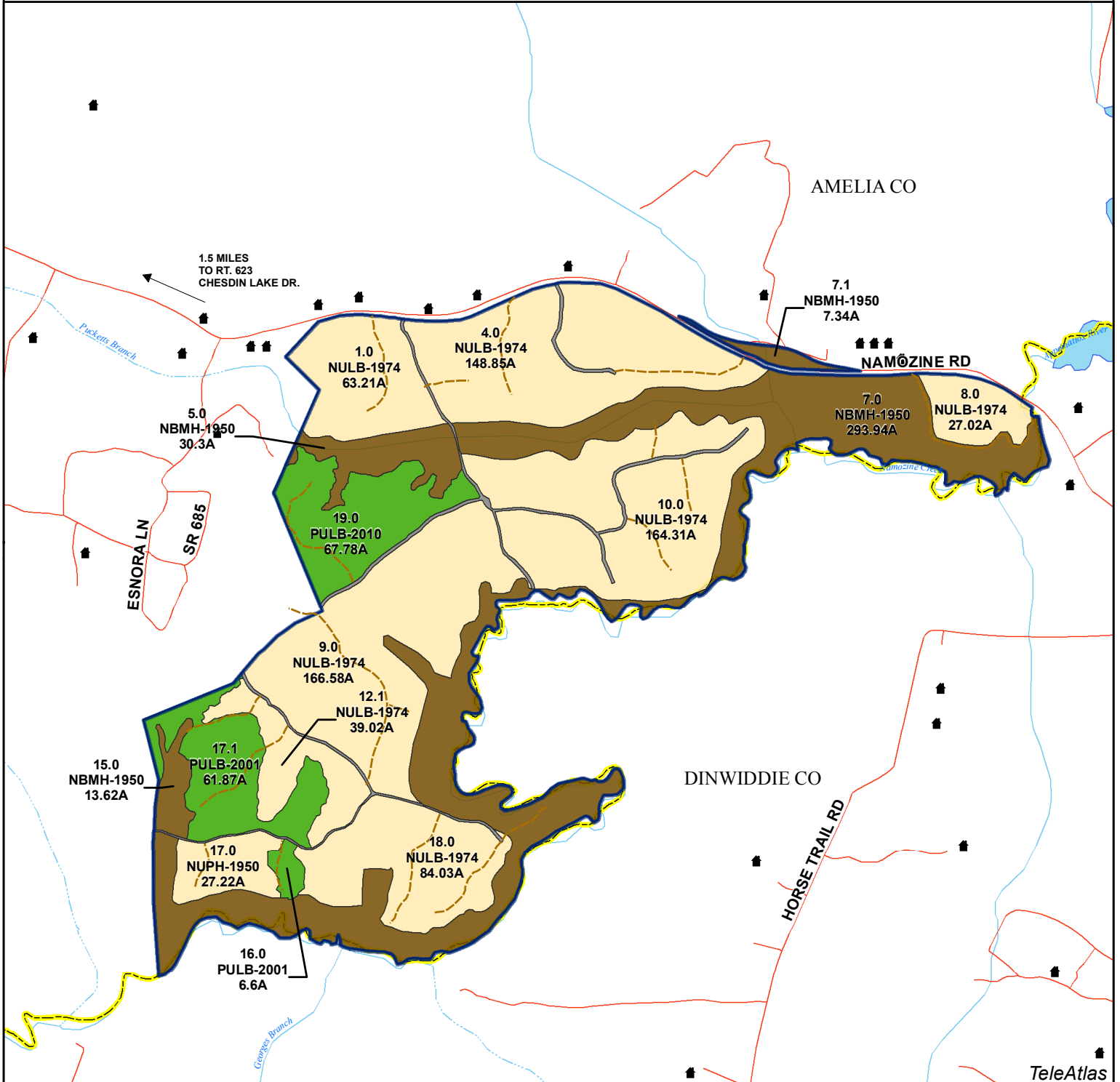
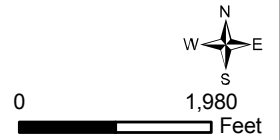

Stand Nomenclature		Stand Origin Codes
Stand #	Description	P = Planted
Acres		N = Natural
Stand Origin	Land Type	B = Bottomland
Land Type		L = Lowland
Dominant Species	Secondary Species	U = Upland
Year of Origin		O = Old Field
		S = Slope

**Note:**

- Road polygons are not annotated
- Stand type acres report restricted to compartment area of interest
- Road data is not digitized & has been provided via ESRI data & maps 9.3.1 datasets.

Stand Types (total acres)	
	Non Timbered (19.21 acres)
	Natural Bottomland (345.20 acres)
	Natural Upland (720.24 acres)
	Planted Upland (136.25 acres)

